

***“When Safety and Productivity  
are a priority, superior illumination  
during darkness is essential”***

# **Work Lamps**

*A large percentage of New Zealand's productive workforce are employed in Agriculture, Horticulture, Forestry, Fisheries, Mining and Roadworks. Working hours are extended into darkness.*

*Effective and efficient mobile lighting is an essential safety element and a mandatory obligation to protect staff from accidents.*



# **Work Lamps**

<i>Work Lamps Introduction</i>	<b>98-101</b>
<i>Xenon AS 300/AS 400</i>	<b>102</b>
<i>Xenon Ultra Beam</i>	<b>103</b>
<i>LED Power Beam 1000</i>	<b>104</b>
<i>LED Mega Beam/LED M70</i>	<b>105</b>
<i>LED Power Beam 2000</i>	<b>106</b>
<i>Halogen Oval 100 FL/M70</i>	<b>107</b>
<i>Halogen Double Beam</i>	<b>108</b>
<i>Halogen Double Beam Oval 100</i>	<b>109</b>
<i>Halogen Oval 100</i>	<b>110</b>
<i>Halogen Picador</i>	<b>111</b>
<i>Halogen Ultra Beam</i>	<b>112-113</b>
<i>Halogen Single Beam</i>	<b>114</b>
<i>Halogen/Sealed Single Beam</i>	<b>115</b>
<i>Reversing Spot</i>	<b>116</b>
<i>Hand Held Spot</i>	<b>117</b>
<i>Spare Parts and Accessories</i>	<b>118-119</b>



**SAFETY through  
Vision and Innovation**



# Work Lamp Technology

## Work Place Safety

A large percentage of New Zealand's productive workforce is employed in the outdoors, in agriculture, horticulture, forestry, fisheries, mining and roadworks to name just a few.

To enhance productivity and improve the utilization of capital intensive farming equipment and machinery, working hours are extended into the night. In the case of road works on major arterial roads, work is always conducted at night to avoid major traffic delays during daytime and particularly rush hour.

Good lighting of the outdoor workplace is an essential safety element and a mandatory obligation to protect valuable equipment and operators from accidents.

The superior performance of Hella work lamps is recognised by equipment manufacturers and operators worldwide. The largest agriculture and construction equipment manufacturers now specify Hella Lighting as original equipment.

Our Catalogue lists a large range of lamps in Halogen, HID and LED technology to fit most applications.

In heavy-duty work environments, LED and HID work lamps offer decisive advantages over conventional bulb technology. LEDs and HID compared to incandescent bulbs, require significantly less power consumption resulting in minimal strain on both alternator and battery, making LED work lamps the ideal lighting solution for work machines and equipment with low alternator performance or with battery-assisted power supply.

### **LED technology features:**

- High energy efficiency
- Longevity
- Multivolt™ capability
- Vibration resistance
- Dust and moisture sealing

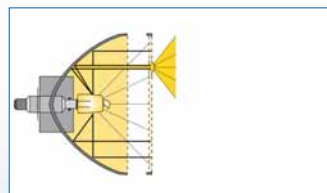

Paraboloid Reflector with Profiled Cover Lens

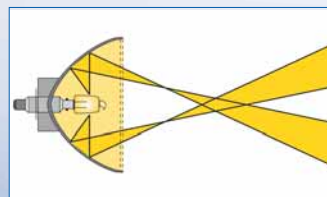
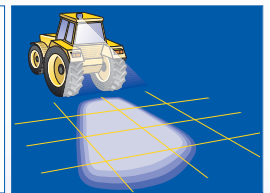

Free-Form (FF) Reflector

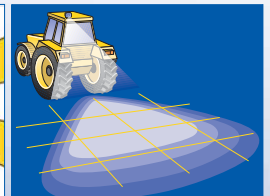

## Reflector Systems used in Hella Work Lamps

### Paraboloid Work Lamp

A conventional work lamp has a reflector in the mathematically defined shape of a paraboloid. The reflector captures the light of the bulb and directs this forward to the area to be illuminated.

The specific light distribution pattern is produced by optical lenses and prisms in the profiled cover lens which achieve limited scattering of the beam of light. Effective paraboloid headlamps need a large reflector in order to be able to capture a large amount of light from the bulb.

### Modern Free-Form (FF) Work Lamps

In contrast to the paraboloid work lamps, the Free-Form (FF) reflector does not incorporate a cover lens that distributes and scatters light. The computer-calculated Free-Form (FF) reflector produces the required beam pattern.

### Free-Form (FF) Work Lamp with H9 Bulbs

Easy replacement of the H9 bulb without having to open the lamp. Hella is the first supplier worldwide to use H9 bulbs in work lamps. The use of H9 bulbs has important advantages for the operator:

- H9 bulbs offer better light output than H3 bulbs. H9 bulbs supply some 45% more luminous flux.
- The bulb is accessible from the outside, which means fast and easy replacement without tools.

### Hints for the Practical Handling of Bulbs

Never touch the glass bulb itself. Fingerprints on the glass bulb burn in an opaqueness which leaves a deposit on the bulb or the reflector. Under such conditions early failure of the bulb cannot be ruled out.

### Innovative Xenon Gas Discharge Technology – High Intensity Discharge (HID)

Unlike conventional bulbs, Xenon bulbs do not have a bulb filament. Rather, the light is produced using an electric arc. A mixture of the inert gas, Xenon, and metallic salts is enclosed in a glass bulb the size of a matchstick head. The light arc is ignited between two electrodes. A sophisticated electronic ballast is necessary for this process.

The high voltage of 20,000 volts necessary for the ignition of the light arc, is produced by a 3rd Generation ballast or in the base of the D1S Xenon bulb. The advantages of work lamps using HID Xenon bulbs in comparison with a 55 watt halogen bulb include the following:

- 2.5 times the luminous flux and at the same time 23% less power consumption.
- Increased luminance results in a brighter and larger illumination of the working area.
- Light spectrum is similar to daylight – for natural colour reproduction of the environment.
- Vibration-proof light arc instead of a sensitive breakable filament.
- Service life up to five times longer – reduced expenditure for bulb replacement.
- Constant brightness – independent of fluctuations in the current supply thanks to the electronic power control in the ballast.

**Note:** To achieve optimum service life of the Xenon bulb (D1S/D2S), the angle of inclination measured from the horizontal position must not exceed +/- 35 degrees. Doing so causes the metallic salts to shift and inhibit a connection between the two electrodes at the time of ignition.

### Advantages of Free-Form (FF) Technology

1. Small Free-Form (FF) reflectors capture more light from the bulb and achieve a considerably larger degree of light effectiveness.
2. Much larger beam scattering can be realised for extremely wide beam patterns.
3. Homogeneous illumination means more pleasant working light with soft transitions at the edges without harsh contrasts.
4. Minimises installation downtime, power and maintenance costs.



### LED Technology

**Crisp White Light**  
**Vibration and Shock Resistant**  
**Low Power Consumption**

### Some Data For Direct Comparison

	H3	H9	D1S D2S	LED
Nominal voltage	12V	12V	85V	9-33V
Nominal capacity	55W	65W	41W	12W
Luminous flux	1450lm	2100lm	3200lm	1000lm
Efficiency	26lm/w	30lm/w	78lm/w	85lm/w
Rated service life	450h	500h	>2000h	10,000+



## Xenon Gas Discharge Lighting

### New 4th Generation Ballast

Hella is one of the leading designers and manufacturers of electronic ballasts for HID lamps.

Many millions of the first three generations of ballasts are installed in vehicles around the globe. The 4th Generation Ballast is another milestone for our engineering team.

The 4th Generation Ballast offers some advanced features and decisive advantages:

- **No high Voltage cable between Ballast and HID bulb.**

In contrast to work lamps with 3rd Generation Ballast, the high starting voltage is generated in the protected bulb socket of the D1 HID bulb. The complex and costly high voltage plug to connect the HID bulb has been eliminated.

A highly flexible connection cable with a much smaller diameter connector offers a flexibility of luminaire design and lamp installation.

- **Cable length between ballast and lamp of up to 3m.**

The much longer cable between ballast and lamp offers the installer a much greater degree of flexibility.

- **Electronic ballast can be separated from the lamp.**

A plug-in connection on the 4th Generation ballast makes it possible to remove the connection cable to the headlamp. This means the connection cable can be fed through an opening in the bodywork and the ballast mounted inside the vehicle. This makes mounting even easier.



3rd Generation ballast firmly connected to the work lamp and Xenon D2S bulb



4th Generation ballast can be separated from the headlamp and Xenon D1S bulb



### Tips for Better Lighting

1. Beam distribution is very important. Make sure you choose a beam pattern which suits your application.
2. Always use quality cable, relays and switches. Hella has a complete range available - ask your supplier for more information.
3. For more flexible illumination with greater manoeuvrability, consider using a pedestal mounting bracket.

### Mounting and operation of lamps with Xenon gas discharge lighting technology.

- Work lamps are supplied with wiring harness, relay and fuse for connection to vehicle. The start-up current of 20A (for 12V) or 10A (for 24V) requires a relay under all circumstances. A 15A fuse is required (for 12 and 24V systems).
- When extending the power supply wiring harness, sufficient cross section must be ensured. The internal resistance of the electrical connection (including relay, fuse and earth lead) between ballast and battery, must not exceed 150 milliohms (for 12V) or 300 milliohms (for 24V) under all circumstances. If the resistance is higher, the current of 20A (for 12V) or 10A (for 24V) required for ignition of the light arc cannot be reached. Insufficient voltage will cause damage to the electronic system.
- Ignition problems can occur with Xenon lamps when a number of ballast units are started simultaneously. This can result in damage to the electronic components. For this reason, the start up of several Xenon lamps should be staggered. The duration of this interval depends on the vehicle's electrical equipment. Due to the design of the HID bulb, the angle of the inclination measured from the horizontal position, must not exceed +/- 35 degrees. A greater angle of inclination will reduce the lifetime of the bulb.

## What Does IP (International Protection) Degree of Protection Mean?

The IP degrees of protection are defined by DIN 40 050 part 9. The purpose of the standard is to define the protection of electrical equipment in vehicles against penetration by foreign particles including dust, and against ingress of water. The exact definition of the degree of protection is achieved by means of different tests. Hella work lamps fulfil at least IP 5K4K (protection against dust and water splashing).

The IP ratings of Hella work lamps are explained in more detail.

Example: **IP 5 6**

First characteristic numeral - protection against the ingress of solid foreign objects (table 1)

Second characteristic numeral - protection against the ingress of water (table 2)

Table 1:

Protection Against the Ingress of Solid Foreign Objects (including dust)	
X	Not tested
0	Not protected
1	Solid foreign objects $\geq 50\text{mm}$
2	Solid foreign objects $\geq 12.5\text{mm}$
3	Solid foreign objects $\geq 2.5\text{mm}$
4	Solid foreign objects $\geq 1.0\text{mm}$
5 and 5K	Dust protected
6 and 6K	Dust tight

Table 2:

Protection Against the Ingress of Water	
X	Not tested
0	Not protected
1	Water vertical dripping
2	Water dripping (inclined 15 degrees)
3	Water spraying
4	Water splashing
4K	Water splashing with increased pressure
5	Water jets
6	Powerful water jets
6K	Powerful water jets at increased pressure
7	Temporary immersion
8	Continuous immersion
9K	High-pressure/steam jet cleaning

## Beam Patterns

Hella's extensive range of work lamps are available in three different beam patterns as shown below.

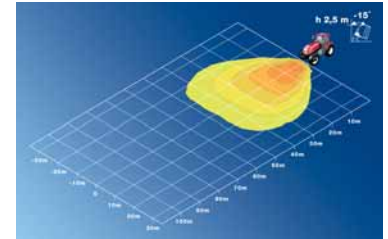

Close range concentrated - for intense illumination of a small area

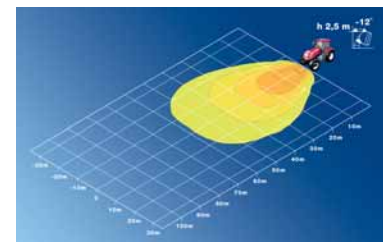

Medium range wide spread - for strong illumination of a fairly large area

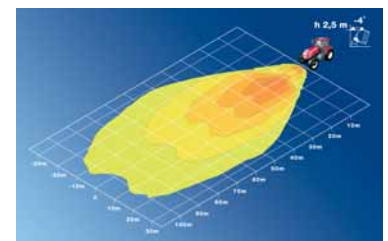

Long range wide spread - for illumination of the greatest area

Work lamps with this symbol are approved for mounting on transport equipment which corresponds to the requirement of GGVS/ADR.

GGVS/ADR = International agreement concerning the carriage of dangerous goods by road.



**NEW  
ENTRY**



**HID** Bulb Incl.  
**HID** Bulb Incl.

## AS 300 Xenon

**1548**

Close Range Gas Discharge Work Lamp - 12 Volt

**1548-24V**

Close Range Gas Discharge Work Lamp - 24 Volt

### DESCRIPTION

AS 300 Xenon Gas Discharge work lamp with Free-Form (FF) reflector for close range, wide spread illumination. Featuring a sturdy plastic housing made of flame retardant UV resistant polymers that protect the lamp in the most demanding temperatures and working conditions. Xenon ballast is integrated into the housing. Built-in handle for ease of directional movement. Relay and cable set included.

### MOUNTING

Upright mounting with M10 mounting bolt and heavy duty bracket.

### POWER

### CONSUMPTION

42W

### BULB TO SUIT

D1S

### PROTECTION

IP 6K7 (Protection against temporary water immersion)

IP 6K9K (Protection against dust and high-pressure/steam jet cleaning)

### SPARE PARTS

- 9.1534G5.01 Close range insert
- 9.1549.02 Long range insert
- 9.1534G4.03 12V ballast
- 9.1535G4.03 24V ballast
- 9.1549.05 Deutsch plug and 2.5m sheathed cable

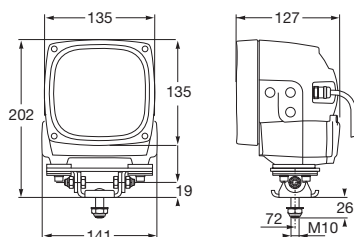

**Metal Body**



**HID** Bulb Incl.  
**HID** Bulb Incl.

## AS 400 Xenon

**1549**

Close Range Gas Discharge Work Lamp - 12 Volt

**1549-24V**

Close Range Gas Discharge Work Lamp - 24 Volt

### DESCRIPTION

AS 400 Xenon Gas Discharge work lamp with Free-Form (FF) reflector for close range, wide spread illumination. Featuring a solid alloy body. Xenon ballast is integrated into the housing. Built-in handle for ease of directional movement. Relay and cable set included.

### MOUNTING

Upright mounting with M10 mounting bolt and heavy duty bracket.

### POWER

### CONSUMPTION

42W

### BULB TO SUIT

D1S

### PROTECTION

IP 6K7 (Protection against temporary water immersion)

IP 6K9K (Protection against dust and high-pressure/steam jet cleaning)

### SPARE PARTS

- 9.1534G5.01 Close range insert
- 9.1549.02 Long range insert
- 9.1534G4.03 12V ballast
- 9.1535G4.03 24V ballast
- 9.1549.05 Deutsch plug and 2.5m sheathed cable

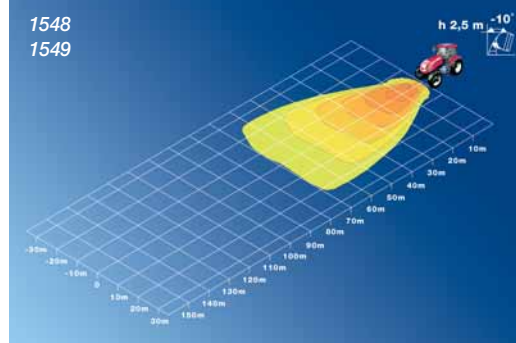
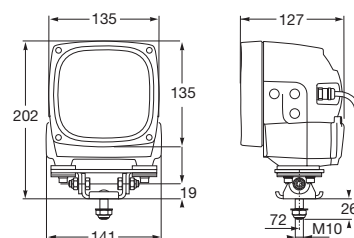



## 1534-G5

Close Range Gas Discharge Work Lamp - 12 Volt

## 1535-G5

Close Range Gas Discharge Work Lamp - 24 Volt

**DESCRIPTION** Ultra Beam Xenon Gas Discharge work lamp, features integrated 5th Generation electronic ballast technology and Free-Form (FF) reflector for close range, wide spread illumination.

**MOUNTING** Suitable for upright mounting with four point stainless steel mounting bracket.

**POWER CONSUMPTION** 42W

**BULB TO SUIT** D1S

**PROTECTION** IP 6K7 (Protection against temporary water immersion)  
IP 6K9K (Protection against dust and high-pressure/steam jet cleaning)

**SPARE PARTS** 9.1534G5.01 Close range insert  
9.1549.05 Deutsch plug and 2.5m sheathed cable

Bulb Incl. **HID**  
Bulb Incl. **HID**

**NEW**  
ENTRY

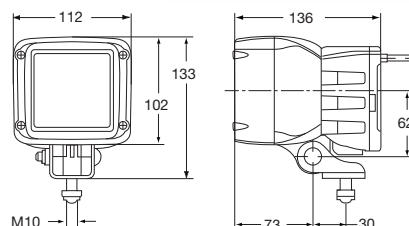
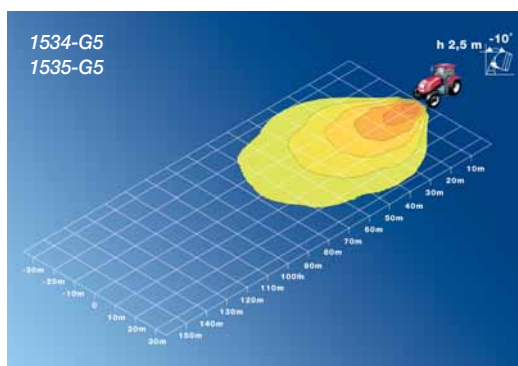

Note: Above diagram is shown with optional supplied mounting bracket.

WORK LAMPS



Heavy-duty work environments require superior illumination



**NEW**  
ENTRY

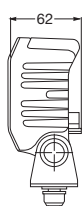
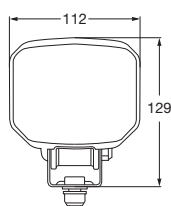

**LED**  
Multivolt

**1551**

*Power Beam 1000 LED Work Lamp*

**DESCRIPTION** LED work lamp with 6 high performance LEDs for powerful white light output. Features robust aluminium die-cast housing, stainless steel bracket and Free-Form (FF) reflector with clear lens for consistent close range illumination. Integrated Deutsch DT socket electrical connection. Lens made from PMMA (acrylic).

**MOUNTING** Upright or pendant mounting.

**VOLTAGE** Multivolt™ for optimum brightness at input voltages from 9 to 33 volts.

**POWER CONSUMPTION** Less than 18W

**MAX. LIGHT OUTPUT** 1000lm

**PROTECTION** Reverse polarity and voltage spike protection.  
IP 6K7 (Protection against temporary water immersion)  
IP 6K9K (Protection against dust and high-pressure/steam jet cleaning)

**CABLE LENGTH** Supplied with DT plug and 2.5m twin core sheathed cable

**ACCESSORY PART** 9.1549.05 Plug and lead (see page 119)

WORK LAMPS

**NEW**  
ENTRY

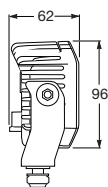
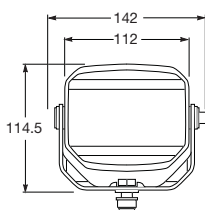

**LED**  
Multivolt

**1551-HD**

*Power Beam 1000 LED Work Lamp - Heavy Duty*

**DESCRIPTION** LED work lamp with 6 high performance white LEDs for powerful white light output. Features robust aluminium die-cast housing, stainless steel heavy duty bracket and Free-Form (FF) reflector with clear hardened glass lens for consistent close range illumination. Integrated Deutsch DT socket electrical connection.

**MOUNTING** Upright or pendant mounting.

**VOLTAGE** Multivolt™ for optimum brightness at input voltages from 9 to 32 volts.

**POWER CONSUMPTION** Less than 18W

**MAX. LIGHT OUTPUT** 1000lm

**PROTECTION** Reverse polarity and voltage spike protection.  
IP 6K7 (Protection against temporary water immersion)  
IP 6K9K (Protection against dust and high-pressure/steam jet cleaning)

**CABLE LENGTH** Supplied with DT plug and 2.5m twin core sheathed cable.

## 1539-LED

### Close Range Mega Beam LED Work Lamp

**LED**  
Multivolt

**600 Lumen**

**NEW**  
ENTRY



<b>DESCRIPTION</b>	Mega Beam Generation 2 LED Multivolt™ work lamps feature 4 high performance white LEDs providing consistent close range illumination with 12V or 24V DC systems. High-sheen metallised Free-Form (FF) reflector and clear glass lens. Housed in an impact resistant aluminium die cast and UV plastic housing, fully sealed for an ultra long service life in demanding high vibration environments.
<b>MOUNTING</b>	Upright mounting with M10 mounting bolt.
<b>VOLTAGE</b>	Multivolt™ for consistent brightness at input voltages from 9 to 33 volts.
<b>POWER CONSUMPTION</b>	15W
<b>MAX. LIGHT OUTPUT</b>	600lm
<b>PROTECTION</b>	Reverse polarity and voltage spike protection. IP 6K7 (Protection against temporary water immersion) IP 6K9K (Protection against dust and high-pressure/steam jet cleaning)
<b>CABLE LENGTH</b>	Pre-wired with 2m of cable.

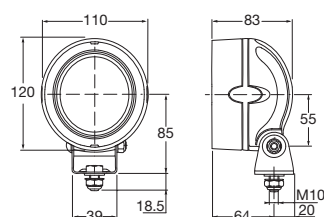

## 1547-LED

### Close Range M70 LED Work Lamp

**LED**  
Multivolt

**600 Lumen**

**NEW**  
ENTRY



<b>DESCRIPTION</b>	M70 LED Multivolt™ work lamp features 4 high performance white LEDs providing consistent close range illumination and lamp protection with 12V or 24V systems. High-sheen metallised Free-Form (FF) reflector and clear glass lens. Housed in an impact resistant aluminium die cast housing, fully sealed for an ultra long service life in demanding high vibration environments.
<b>MOUNTING</b>	Upright mounting M10 mounting bolt.
<b>VOLTAGE</b>	Multivolt™ for consistent brightness at input voltages from 9 to 33 volts.
<b>POWER CONSUMPTION</b>	15W
<b>MAX. LIGHT OUTPUT</b>	600lm
<b>PROTECTION</b>	Reverse polarity and voltage spike protection. IP 6K7 (Protection against temporary water immersion) IP 6K9K (Protection against dust and high-pressure/steam jet cleaning)
<b>CABLE LENGTH</b>	Pre-wired with 2m of cable.

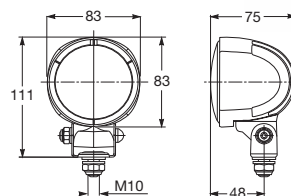

1539-LED

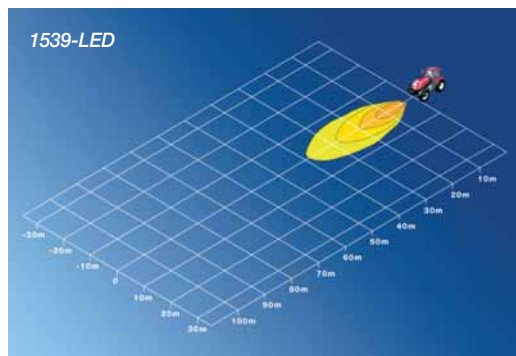

1547-LED

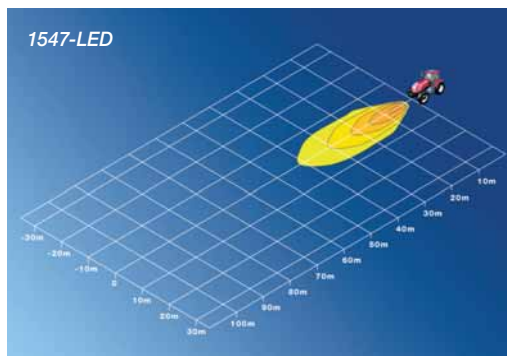



**NEW**  
ENTRY

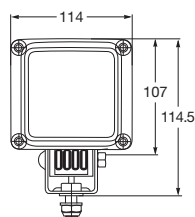

**LED**  
Multivolt

**1553**

*Power Beam 2000 LED Work Lamp*

**DESCRIPTION**

LED work lamp with 16 high performance LEDs for powerful white light output rated at 2200 lumens, over 50% brighter than a 55W H3 bulb, while consuming 20% less power. Features robust aluminium die-cast housing, stainless steel heavy duty bracket and hardened glass lens for consistent close range illumination. Integrated Deutsch DT socket electrical connection.

**VOLTAGE**

Multivolt™ 9 to 33 volts.

**POWER CONSUMPTION**

43W

**MAX. LIGHT OUTPUT**

2200lm

**PROTECTION**

Reverse polarity and voltage spike protection.  
IP 6K6 (Protection against dust and high pressure water jets)  
IP 6K7 (Protection against temporary water immersion)

**CABLE LENGTH**

Supplied with DT plug and 2.5m twin core sheathed cable.

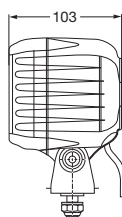

WORK LAMPS

**NEW**  
ENTRY

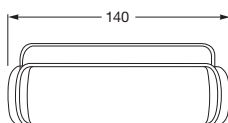

**LED**  
Multivolt  
**LED**  
Multivolt

**98067020**

*LED Work Lamp - Narrow Beam*

**98067030**

*LED Work Lamp - Spread Beam*

**DESCRIPTION**

LED universal work lamp with low profile stainless steel bracket. Lamp may be mounted upright or pendant, and may be adjusted vertically up or down. Totally sealed against dust and moisture and with a tough, chemical resistant Grilamid® lens. Option of two light patterns, spread or narrow.

**VOLTAGE**

Multivolt™ for optimum brightness at input voltages from 9 to 33 volts.

**POWER**

**CONSUMPTION**

3W

**CABLE LENGTH**

2.5m twin core sheathed cable.

**LENS MATERIAL**

Grilamid®

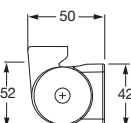

**1554**

*Close Range Oval 100 Double Beam Work Lamp - 12 Volt*

**12V Bulb Incl.**

**DESCRIPTION** Oval 100 double beam Halogen work lamp with solid alloy Free-Form (FF) reflector for close range illumination. Has two distinct patterns for use with fork lifts and other lifting vehicles. Lower beam illuminates the roadway and the upper beam illuminates the load and/or loading area. Sturdy glass reinforced plastic housing and glass lens.

**MOUNTING** Pendant mounting with M10 mounting bolt.

**POWER CONSUMPTION** 12V - 110W  
24V - 140W

**BULBS TO SUIT** 12V YC1255 x 2  
24V YC2470 x 2

*Note Not suitable for 100W bulbs.*

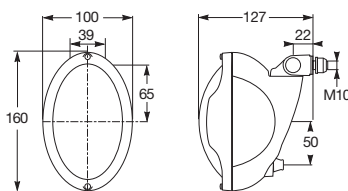

*Oval 100 FL Work Lamp: Recorded with single lamp. Pattern shown @ 10 metres from lamp.*

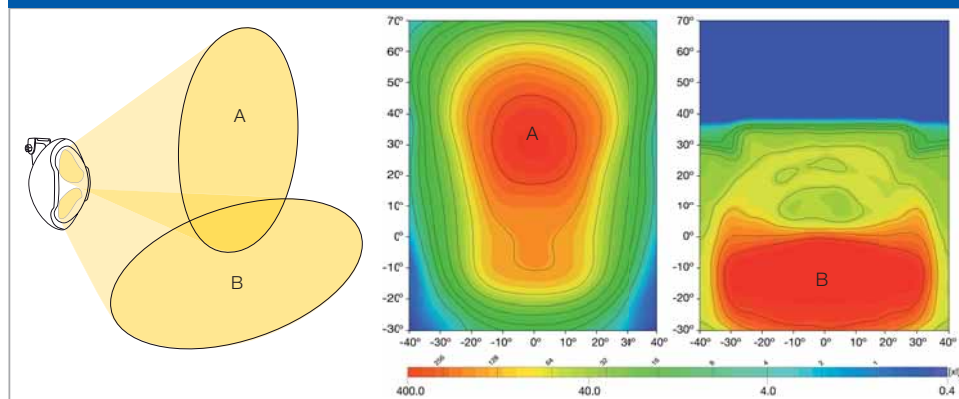

WORK LAMPS

**1547**

*Close Range Halogen Work Lamp - 12 Volt*

**12V Bulb Incl.**

**1547-24V**

*Close Range Halogen Work Lamp - 24 Volt*

**24V Bulb Incl.**

**1547-P**

*Close Range Halogen Work Lamp  
Pendant Mount - 12 Volt*

**12V Bulb Incl.**

**1547-P24V**

*Close Range Halogen Work Lamp  
Pendant Mount - 24 Volt*

**24V Bulb Incl.**

**DESCRIPTION** Compact Halogen work lamp with a Free-Form (FF) brilliant round reflector. The non-patterned lens reduces light scatter and provides close range uniform illumination of the work area. Reflector made from die cast aluminium. The lamp's ingenious bracket design allows it to be swivelled 360°, as well as the normal lateral adjustment.

**MOUNTING** With M10 fixing screw for upright mounting 1547 and 1547-24V. Pendant mounting 1547-P and 1547-P24V.

**POWER CONSUMPTION** 12V - 55W  
24V - 70W

**BULBS TO SUIT** 12V YC1255  
24V YC2470

**PROTECTION** IP 5K9K (Protection against dust and high-pressure/steam jet cleaning)

*Note Not suitable for 100W bulbs.*

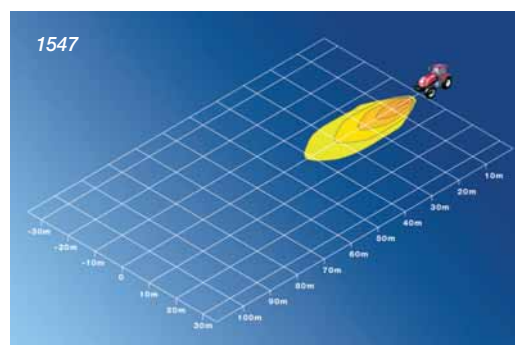
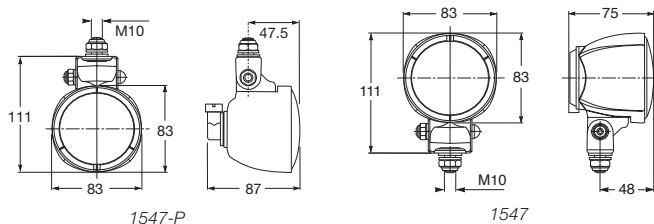



# Work Lamps Halogen Double Beam

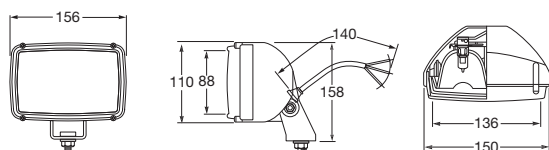

12V Bulb Incl.

**1530**

Long Range Halogen Work Lamp - 12 Volt

24V Bulb Incl.

**1530-24V**

Long Range Halogen Work Lamp - 24 Volt

## DESCRIPTION

Halogen work lamp with double Free-Form (FF) reflector for long range, wide spread illumination. Black fibre reinforced plastic housing with extended edge to protect lens. 250mm long silicone connection cables.

## MOUNTING

Single bolt with tilt adjustment. Upright or pendant mounting.

## POWER

## CONSUMPTION

110W (2 x 55W)

## BULBS TO SUIT

12V 2 x YC1255  
24V 2 x YC2455

## PROTECTION

IP 5K4K (Protection against dust and water splash)

## SPARE PARTS

9.1530.01 Long range insert  
9.1530.07 Bracket assembly (stainless steel)

Note Not suitable for 100W bulbs.



12V Bulb Incl.

**1531**

Medium Range Halogen Work Lamp - 12 Volt

24V Bulb Incl.

**1531-24V**

Medium Range Halogen Work Lamp - 24 Volt

## DESCRIPTION

Halogen work lamp with double Free-Form (FF) reflector for close range, wide spread illumination. Black fibre reinforced plastic housing with extending edge to protect lens. With 250mm long silicone connection lead.

## MOUNTING

Single bolt with tilt adjustment. Upright or pendant mounting.

## POWER

## CONSUMPTION

110W (2 x 55W)

## BULBS TO SUIT

12V 2 x YC1255  
24V 2 x YC2455

## PROTECTION

IP 5K4K (Protection against dust and water splash)

## SPARE PARTS

9.1531.01 Close range insert  
9.1530.07 Bracket assembly (stainless steel)

Note Not suitable for 100W bulbs.



12V Bulb Incl.

**1532**

Close Range Halogen Work Lamp - 12 Volt

24V Bulb Incl.

**1532-24V**

Close Range Halogen Work Lamp - 24 Volt

## DESCRIPTION

Halogen work lamp with double Free-Form (FF) reflector for medium range, wide spread illumination. Black fibre reinforced plastic housing with extending edge to protect lens. With 250mm long silicone connection lead.

## MOUNTING

Single bolt with tilt adjustment. Upright or pendant mounting.

## POWER

## CONSUMPTION

110W (2 x 55W)

## BULBS TO SUIT

12V 2 x YC1255  
24V 2 x YC2455

## PROTECTION

IP 5K4K (Protection against dust and water splash)

## SPARE PARTS

9.1532.01 Wide spread insert  
9.1530.07 Bracket assembly (stainless steel)

Note Not suitable for 100W bulbs.

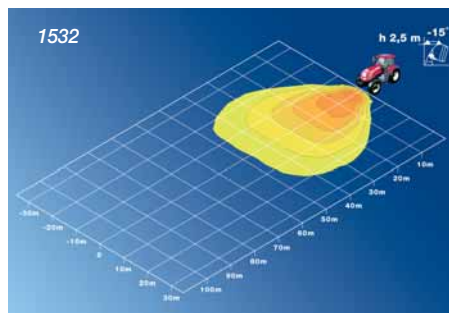
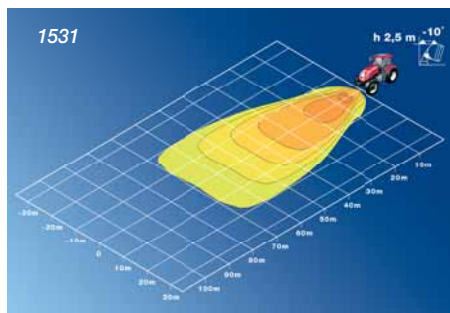
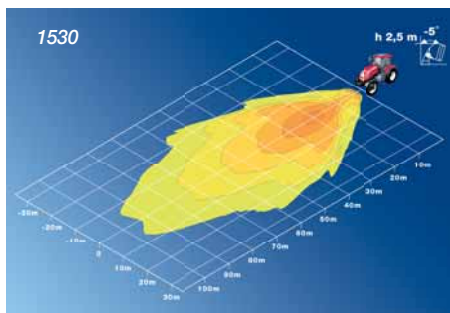

<b>1541</b>	Close Range Halogen Work Lamp - 12 Volt
<b>1541-24V</b>	Close Range Halogen Work Lamp - 24 Volt

**DESCRIPTION** Halogen work lamp with Free-Form (FF) reflector and clear glass lens for close range, wide spread illumination. Sturdy housing design for heavy-duty use.

**MOUNTING** Single bolt with tilt adjustment.

**POWER CONSUMPTION** 110W (2 x 55W)

**BULBS TO SUIT** 12V 2 x YC1255  
24V 2 x YC2455

**PROTECTION** IP 5K4K (Protection against dust and water splash)

**SPARE PARTS** 9.1541.01 Close range insert  
9.1530.07 Bracket assembly (stainless steel)

*Note* Not suitable for 100W bulbs.



<b>1542</b>	Long Range Halogen Work Lamp - 12 Volt
<b>1542-24V</b>	Long Range Halogen Work Lamp - 24 Volt

**DESCRIPTION** Halogen work lamp with Free-Form (FF) reflector for wide spread, long range illumination. The pattern free lens prevents scatter loss and avoids unwanted light reflections outside the illuminated area. Sturdy housing design for heavy-duty use.

**MOUNTING** Single bolt with tilt adjustment.

**POWER CONSUMPTION** 110W (2 x 55W)

**BULBS TO SUIT** 12V 2 x YC1255  
24V 2 x YC2455

**PROTECTION** IP 5K4K (Protection against dust and water splash)

**SPARE PARTS** 9.1542.01 Long range insert  
9.1530.07 Bracket assembly (stainless steel)

*Note* Not suitable for 100W bulbs.

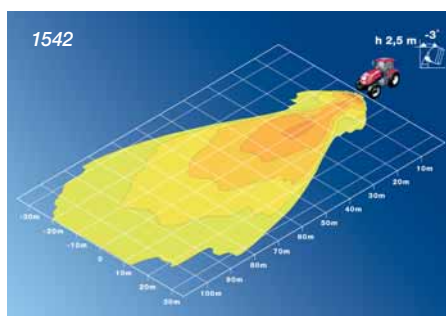
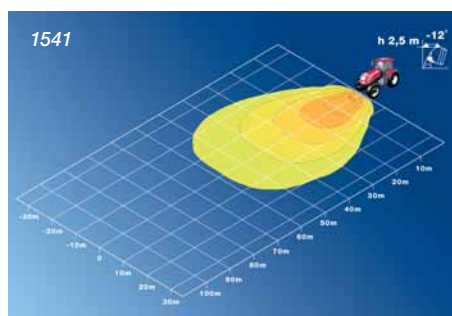





12V Bulb Incl.

**1540**

*Close Range Oval 100 Halogen Work Lamp - 12 Volt*

24V Bulb Incl.

**1540-24V**

*Close Range Oval 100 Halogen Work Lamp - 24 Volt*

## DESCRIPTION

Oval 100 Halogen work lamp with Free-Form (FF) reflector for close range, medium spread illumination. Uniform large surface illumination results in excellent working light. Sturdy housing design for use under heavy-duty conditions.

## POWER

### CONSUMPTION

12V - 55W

24V - 70W

### BULBS TO SUIT

12V

YC1255

24V

YC2470

## PROTECTION

IP 5K4K (Protection against dust and water splash)

## SPARE PARTS

9.1540.01

Insert

9.1533.05

Plug and lead

9.1533.08

Pedestal bracket

*Note Not suitable for 100W bulbs.*

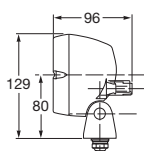
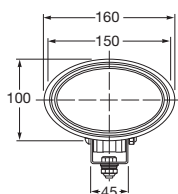

12V Bulb Incl.

**1552**

*Close Range Oval 100 Halogen Work Lamp with Handle and Switch - 12 Volt*

## DESCRIPTION

Oval 100 Halogen work lamp with solid alloy Free-Form (FF) reflector for close range illumination. Comes with handle and switch. Reinforced plastic housing and glass lens. Glass lens protected by extended rim. On/off switch conveniently positioned on the front of the lamp.

## MOUNTING

Upright mounting with four point fixing bracket.

## POWER

### CONSUMPTION

12V - 55W

24V - 70W

### BULBS TO SUIT

12V

YC1255

24V

YC2470

## SPARE PART

9.1540.01

Insert

*Note Not suitable for 100W bulbs.*

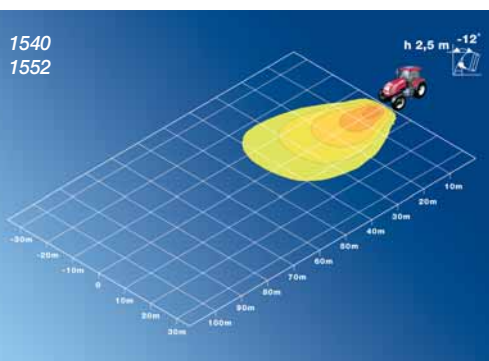
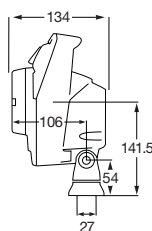
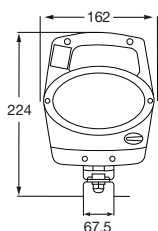

<b>1519</b>	Close Range Halogen Work Lamp - 12 Volt
<b>1519-24V</b>	Close Range Halogen Work Lamp - 24 Volt
<b>1519-SS</b>	Close Range Halogen Work Lamp - 12 Volt
<b>1519-SS24V</b>	Close Range Halogen Work Lamp - 24 Volt

12V Bulb Incl.

24V Bulb Incl.

12V Bulb Incl.

24V Bulb Incl.



**DESCRIPTION** Halogen work lamp with black fibre reinforced ABS housing and Free-Form (FF) reflector for close range, uniform illumination. SS version with stainless steel bracket, bolts and lens screws.

**MOUNTING** Pendant or upright.

**POWER CONSUMPTION** 12V - 55W  
24V - 70W

**BULBS TO SUIT** 12V YC1255  
24V YC2470

**PROTECTION** IP 5K4K (Protection against dust and water splash)

**SPARE PART** 9.2859.02 FF insert

*Note* Not suitable for 100W bulbs.

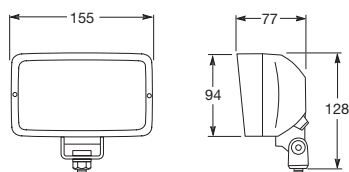

<b>1519-SM</b>	Close Range Halogen Work Lamp - 12 Volt
<b>1519-SM24V</b>	Close Range Halogen Work Lamp - 24 Volt

12V Bulb Incl.

24V Bulb Incl.



**DESCRIPTION** Halogen side mount work lamp with black fibre reinforced ABS housing and Free-Form (FF) reflector for close range, uniform illumination. Universal side bracket with M10 mounting screw for attachment to vertical surfaces.

**MOUNTING** Pendant or upright.

**POWER CONSUMPTION** 12V - 55W  
24V - 70W

**BULBS TO SUIT** 12V YC1255  
24V YC2470

**PROTECTION** IP 5K4K (Protection against dust and water splash)

**SPARE PART** 9.2859.02 FF insert

*Note* Not suitable for 100W bulbs.

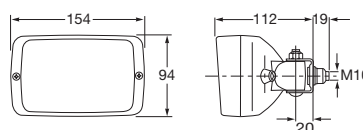

<b>2860-BLACK</b>	Close Range Halogen Work Lamp, Recess Mount - 12 Volt
-------------------	---

12V Bulb Incl.



**DESCRIPTION** Halogen work lamp with recess mount black fibre reinforced ABS housing and Free-Form (FF) reflector for close range, uniform illumination.

**MOUNTING** Recess mount - front inclination +/- 5 degrees.

**POWER CONSUMPTION** 55W

**BULBS TO SUIT** 12V YC1255  
24V YC2470

**PROTECTION** IP 5K4K (Protection against dust and water splash)

**SPARE PART** 9.2859.02 FF insert

*Note* Not suitable for 100W bulbs.

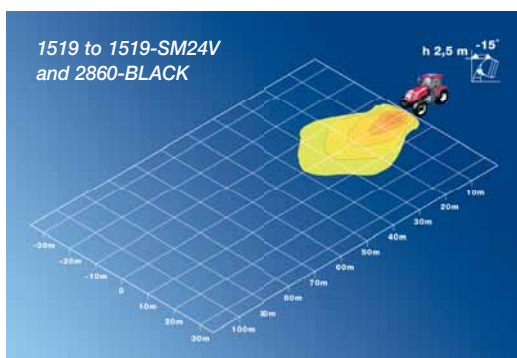
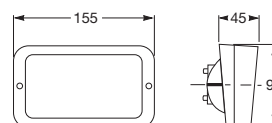

# Work Lamps Halogen Ultra Beam



12V Bulb Incl.

**1533**

Close Range Halogen Work Lamp - 12 Volt



12V Bulb Incl.

**1533-35W**

Close Range Halogen Work Lamp - 12 Volt



24V Bulb Incl.

**1533-24V**

Close Range Halogen Work Lamp - 24 Volt



24V Bulb Incl.

**1533-DT24V**

Close Range Halogen Work Lamp with Deutsch Plug - 24 Volt

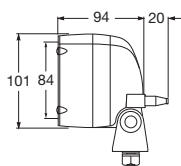
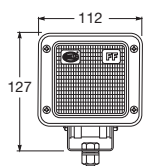

## DESCRIPTION

Halogen work lamp with Free-Form (FF) reflector for uniform close range illumination. Made of die-cast aluminium. Glass lens bonded with reflector to be dust and moisture-proof. Shock-proof plastic housing. External wiring connection. DT version with 2 pin Deutsch rear plug.

## MOUNTING

Suitable for upright, side or pendant mounting through swivelling the lamp unit 90°. U-shape four point fixing bracket with M10 screw for mounting on horizontal and vertical surfaces.

## POWER

### CONSUMPTION

12V - 55W

24V - 70W

### BULBS TO SUIT

12V YC1255, YC1235 (1533-35W)

24V YC2470

### PROTECTION

IP 6K4K (Protection against dust and water splash)

IP X9K (Protection against high pressure jets)

### SPARE PARTS

9.1533.01 Insert  
9.1533.05 Plug and lead  
9.1533.08 Pedestal bracket  
9.1549.05 Deutsch plug and 2.5m sheathed cable (DT)

Note Not suitable for 100W bulbs.



12V Bulb Incl.

**1533-SM**

Close Range Halogen Work Lamp - 12 Volt

24V Bulb Incl.

**1533-SM24V**

Close Range Halogen Work Lamp - 24 Volt

## DESCRIPTION

As per 1533 with side mount.

## MOUNTING

With M10 fixing screw for mounting on vertical surfaces.

Pivot range: horizontal 130°

Inclination range: vertical 90°

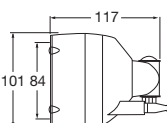
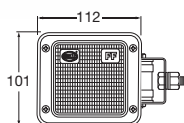

12V Bulb Incl.

**1533-HAN**

Close Range Halogen Work Lamp - 12 Volt



24V Bulb Incl.

**1533-HAN24V**

Close Range Halogen Work Lamp - 24 Volt



12V Bulb Incl.

**1533-SW**

Close Range Halogen Work Lamp - 12 Volt

## DESCRIPTION

As per 1533 with handle. 1533-SW includes switch.

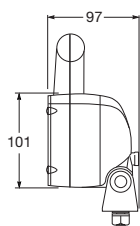
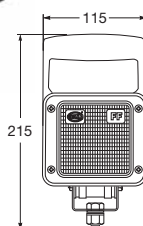



<b>1533-FM</b>	Close Range Halogen Work Lamp - 12 Volt
<b>1533-FM24V</b>	Close Range Halogen Work Lamp - 24 Volt

12V Bulb Incl.

24V Bulb Incl.

**DESCRIPTION** As per 1533 suitable for flush mounting.  
**MOUNTING** Flush mount.

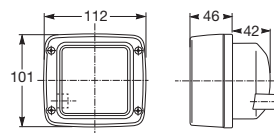

<b>1533-LR</b>	Long Range Halogen Work Lamp - 12 Volt
<b>1533-LR24V</b>	Long Range Halogen Work Lamp - 24 Volt

12V Bulb Incl.

24V Bulb Incl.

**DESCRIPTION** Halogen work lamp with Free-Form (FF) reflector for close range, uniform illumination. Made of die-cast aluminium. Glass lens bonded with reflector to be dust and moisture-proof. Shock-proof plastic housing. External wiring connection.  
**MOUNTING** Suitable for upright, side or pendant mounting through swivelling the lens unit 90°. U-shape bracket with M10 screw for mounting on horizontal and vertical surfaces.

**POWER CONSUMPTION** 12V - 55W  
24V - 70W

**BULBS TO SUIT** 12V YC1255  
24V YC2470

**PROTECTION** IP 6K4K (Protection against dust and water splash)  
IP X9K (Protection against high pressure jets)

**SPARE PARTS** 9.1533.03 Insert  
9.1533.08 Pedestal bracket  
9.1533.05 Plug and lead

*Note Not suitable for 100W bulbs.*

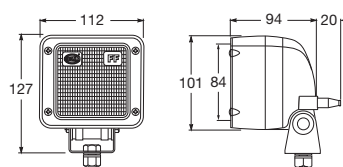

<b>1533-H9</b>	Close Range Halogen Work Lamp with H9 Bulb
----------------	--

12V Bulb Incl.

**DESCRIPTION** The more powerful H9 halogen bulb allows the Ultra Beam work lamp to provide a large light output. The high-shine vapour plated Free-Form (FF) reflector is made of die-cast aluminium. The hardened glass cover lens is bonded tightly to the reflector. The bulb is accessible from the outside for quick bulb replacement without opening the lamp.

**MOUNTING** Suitable for upright, side or pendant mounting through swivelling the lamp unit 90°. U-shape four point fixing bracket with M10 screw for mounting on horizontal and vertical surfaces.

**POWER CONSUMPTION** 65W

**BULB TO SUIT** 12V CF1265

**PROTECTION** IP 5K4K (Protection against dust and water splash)  
IP X9K (Protection against high pressure jets)

**SPARE PARTS** 9.1533.02 Insert H9  
9.1533H9.05 Plug and lead  
9.1533.08 Pedestal bracket

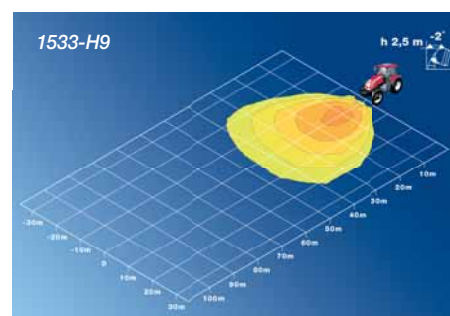
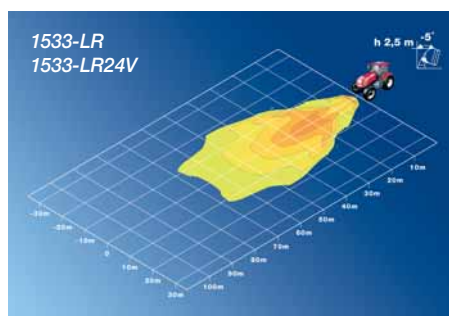
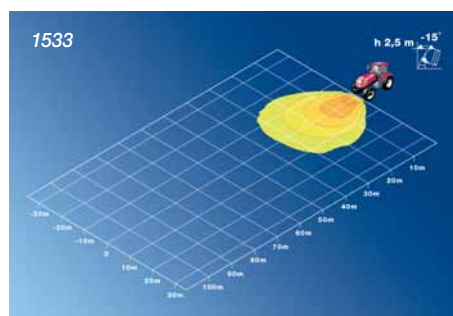
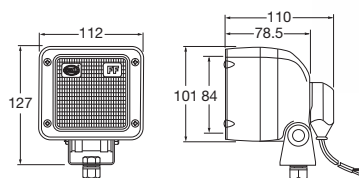



**1500**

*Polycarbonate Lens Work Lamp - 12 Volt*

**DESCRIPTION** Polycarbonate lens work lamp for use in the agriculture and food processing industries, or in situations where lens breakage may occur.

**MOUNTING** Full swivel four point fixing bracket for mounting on flat surfaces.

**BULBS TO SUIT** 12V YC1255  
24V YC2455

**PROTECTION** IP 5K4K (Protection against dust and water splash)

**SPARE PARTS** 9.1500.01 Polycarbonate insert  
9.1533.08 Pedestal bracket

*Note Not suitable for 100W bulbs.*

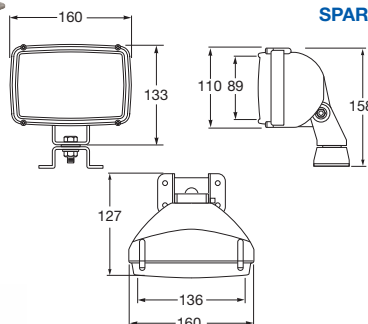

**1501**

*Micro DE Halogen Work Lamp - 12 Volt*

**DESCRIPTION** Compact Micro DE (Dixial Ellipsoid) Halogen work lamp for use in applications with limited mounting space. Concentrated close range illumination. Magnesium housing with U-shaped one point mounting bracket.

**MOUNTING** Pendant or upright.

**POWER CONSUMPTION** 55W

**BULBS TO SUIT** 12V YC1255  
24V YC2455

**PROTECTION** IP 5K4K (Protection against dust and water splash)

**SPARE PART** 9HD 149 253-007 Plastic cap with cable

*Note Not suitable for 100W bulbs.*

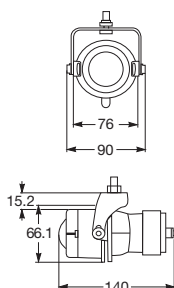

**2859**

*Close Range Halogen Deck Lamp - 12 Volt*

**DESCRIPTION** Halogen deck lamp white fibre reinforced ABS housing and Free-Form (FF) reflector for close range uniform illumination. With stainless steel bracket, bolts and lens screws.

**MOUNTING** Pendant or upright.

**POWER CONSUMPTION** 12V - 55W

**BULBS TO SUIT** 12V YC1255  
24V YC2470

**SPARE PARTS** 9.2859.02 Free-Form (FF) reflector insert  
9.2859.01 Lamp insert to suit early version

*Note Not suitable for 100W bulbs.*

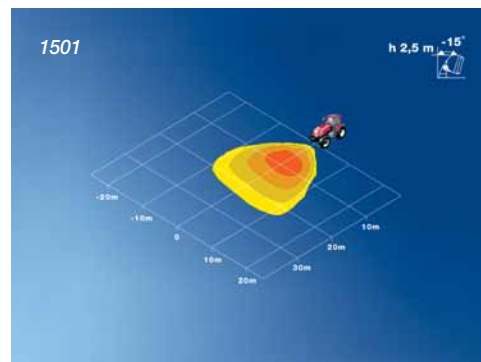
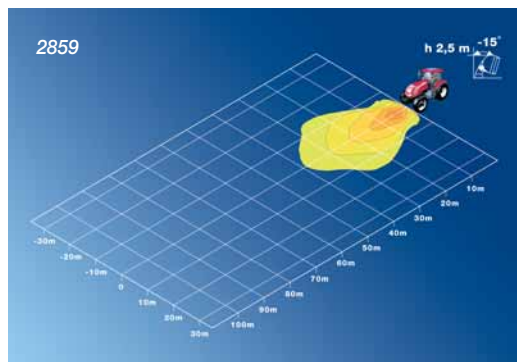
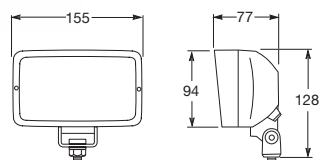

<b>1509</b>	<i>Close Range Sealed Beam Work Lamp - 12 Volt</i>
<b>1509/1096</b>	<i>Close Range Sealed Beam Work Lamp - 24 Volt</i>

<b>DESCRIPTION</b>	Rubber bodied work lamp with sealed beam insert.	
<b>MOUNTING</b>	Single bolt. Vertical swivel, bracket included.	
<b>POWER CONSUMPTION</b>	60W	
<b>SPARE PARTS</b>	1078	Sealed beam 12V 60W
	1096	Sealed beam 24V 60W
	9.1509.01	Rubber body and plug
	9.1509.02	Rubber plug

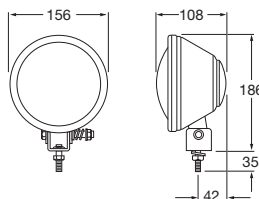

<b>1511</b>	<i>Close Range Halogen Work Lamp - 12 Volt</i>
<b>1511-24V</b>	<i>Close Range Halogen Work Lamp - 24 Volt</i>
<b>1512</b>	<i>Long Range Halogen Work Lamp - 12 Volt</i>
<b>1513</b>	<i>Combination Range Halogen Work Lamp - 12 Volt</i>

<b>DESCRIPTION</b>	Work lamp with handle and switch. Black fibre-glass reinforced plastic housing with extended edge to protect lens.	
<b>MOUNTING</b>	Full swivel four point fixing bracket for mounting on flat or slightly curved surfaces.	
<b>POWER CONSUMPTION</b>	12V - 55W 24V - 70W	
<b>BULBS TO SUIT</b>	12V	YC1255
	24V	YC2470
<b>PROTECTION</b>	IP 5K4K (Protection against dust and water splash)	
<b>SPARE PARTS</b>	9.1511.01	Close range insert
	9.1511.06	On/off rotary switch
	9.1511.08	Mounting bracket assembly
	9.1512.01	Long range insert
	9.1513.01	Combination range insert

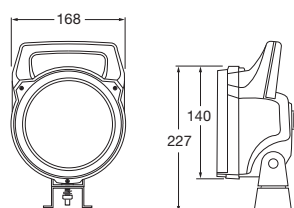

<b>1514</b>	<i>Close Range Halogen Work Lamp - 12 Volt</i>
-------------	--

<b>DESCRIPTION</b>	Close range, wide spread rubber bodied work lamp with semi-sealed Halogen insert.	
<b>MOUNTING</b>	Single bolt. Vertical swivel with bracket included.	
<b>VOLTAGE</b>	12V	
<b>POWER CONSUMPTION</b>	55W	
<b>BULBS TO SUIT</b>	12V	YC1255
	24V	YC2470
<b>PROTECTION</b>	IP 5K4K (Protection against dust and water splash)	
<b>SPARE PARTS</b>	9.1511.01	Insert
	9.1514.09	Rubber body

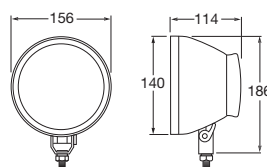



## Reversing Spot Lamps



## Optically the same - technically different

It's certainly true that on the outside, Hella Reversing Spot Lamps look like conventional fog lights or work lights. However, the difference is in the detail. Hella reversing Spot Lamps have a different light distribution and have a special type-approval. Only Reversing Spot Lamps with a corresponding type-approval symbol are approved for additional mounting to the commercial vehicle and trailer. Type-approval identification: 00 AR stands for reversing spotlight



### 1533-RE24V

### Reversing Spot Lamp - 24 Volt



**DESCRIPTION** Reversing Spot Lamps with 70W bulb, approved for use in New Zealand. Provides maximum visibility of the rear and/or sides during reversing manoeuvres. Equipped with die-cast aluminium Free-Form (FF) reflector and patterned glass lens for a broad and uniform illumination without harsh contrasts. Sturdy design and shock-proof plastic housing for use under heavy-duty conditions.

**MOUNTING** Single M10 mounting bolt with tilt adjustment. Upright horizontal mounting. Inclination has to be 12° downwards.

**POWER CONSUMPTION** 70W

**BULBS TO SUIT**  
12V YC1255  
24V YC2470

**PROTECTION** IP 6K4K (Protection against dust and water splash)  
IP X9K (Protection against high pressure jets)

**SPARE PARTS** 9.1533RE.01 Insert  
9.1533.05 Plug and lead

**COMPLIANCE** E12 23005

*Note Fully compliant with 3rd edition ADR 1/00 reversing Spot Lamp. Not suitable for 100W bulbs.*

**NEW ENTRY**



### 1502-RE24V

### Reversing Spot Lamp - 24 Volt



**DESCRIPTION** ECO 21 Reversing Spot Lamps with 21W bulb, approved for use in New Zealand. Low cost plastic reversing Spot Lamp with economical 21W bulb.

**MOUNTING** Single M10 mounting bolt.

**POWER CONSUMPTION** 21W

**BULBS TO SUIT**  
12V R1221  
24V R2421

**PROTECTION** IP 6K9K (Protection against dust and high-pressure/steam jet cleaning)

**COMPLIANCE** E4 23262

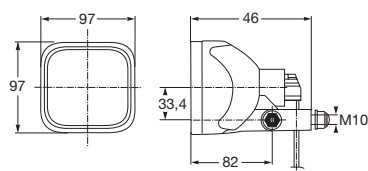

## 1520 Long Range Hand Held Spot Lamp - 12 Volt 100 Watt

**DESCRIPTION** Blue hand held long range spot lamp. Includes plug, spiral cable (extendable to 2m) and on/off switch.

**VOLTAGE** 12V sealed beam included.

**POWER CONSUMPTION** 100W

**SPARE PARTS** 1089 Sealed beam  
9.1520.06 Switch - on/off

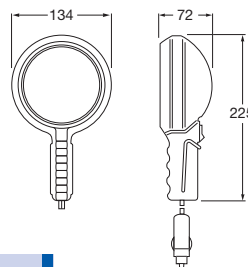

## 1521 Hand Held Spot Lamp - 12 Volt 30 Watt

**DESCRIPTION** As per 1520 with 12V - 30W sealed beam.

**SPARE PART** 1087 Sealed beam

## 1525 Hand Held Spot Lamp - 24 Volt 50 Watt

**DESCRIPTION** As per 1520 with 24V - 50W sealed beam.

**SPARE PART** 1092 Sealed beam

## 1524 Long Range Hand Held Spot Lamp - 12 Volt 100 Watt

**DESCRIPTION** Black hand held long range spot lamp. Includes plug, spiral cable (extendable to 2m) and momentary pressure contact on/off switch. Black body.

**VOLTAGE** 12V sealed beam included.

**POWER CONSUMPTION** 100W

**SPARE PARTS** 1089 Sealed beam  
9.1524.06 Switch - Momentary

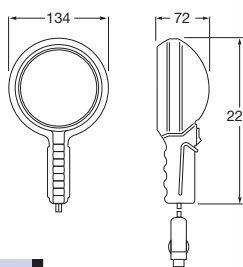

## 1524-S Hand Held Spot Lamp - 24 Volt 60 Watt

**DESCRIPTION** As per 1524 with 24V - 60W sealed beam.

**SPARE PART** 1092 Sealed beam

## 2864 Close Range Hand Held Spot Lamp - 12 Volt

**DESCRIPTION** Waterproof close range search lamp with twin Free-Form (FF) reflectors. 2 bulbs (55W and 100W) with separate switches provide optimum illumination of the immediate vicinity, precise illumination at a distance or both. Spiral cable and plug will extend to 3.5m.

**PROTECTION** IP X6K (Protection against powerful water jets at increased pressure)

**BULBS TO SUIT** 12V 24V  
YC1255 YC2470 (2 bulbs)  
YC12100

**SPARE PARTS** 9.2864.01 Insert  
9.2864.08 Mounting bracket  
9.2864.07 Plug, cable and grip

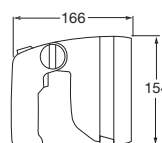
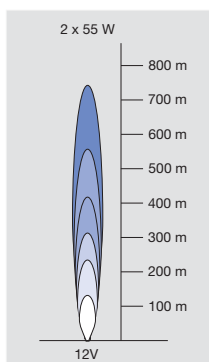



**5DV 007 760-631**

*HID Gas Discharge Power Pack (G3) - 12 Volt*

**5DV 007 780-171**

*HID Gas Discharge Power Pack (G3) - 24 Volt*

**DESCRIPTION** HID gas discharge power pack to suit Generation 3 (G3) work lamps and headlamps.

**SPARE PARTS** 9.1534.05 2 pin connector



**9.1534.03**

*HID Gas Discharge Power Pack (G3) - 12 Volt*

**9.1535.03**

*HID Gas Discharge Power Pack (G3) - 24 Volt*

**DESCRIPTION** HID gas discharge power pack with alloy mounting bracket. To suit Generation 3 (G3) work lamps and headlamps.

**SPARE PARTS** 9.1534.05 2 pin connector



**9.1534G4.03**

*HID Gas Discharge Power Pack (G4) - 12 Volt*

**9.1535G4.03**

*HID Gas Discharge Power Pack (G4) - 24 Volt*

**DESCRIPTION** HID gas discharge power pack with alloy mounting bracket. To suit Generation 4 (G4) work lamps and headlamps.

**SPARE PARTS** 9.1549.05 Deutsch plug and 2.5m sheathed cable

**Safety through  
superior illumination**





### 9.1530.07 *Stainless Steel Bracket Assembly*

**DESCRIPTION** Upper and lower stainless steel bracket and lamp mounting bolt. Suitable for 42mm wide lamp mounts.

**TO SUIT** P/N's 1500, 1530-32, 1533-35, 1540-42, 1551



### 9.1530.08 *Upper U Bracket*

**DESCRIPTION** Upper stainless steel bracket, suitable for 42mm wide lamp mounts.

**TO SUIT** P/N's 1500, 1530-32, 1533-35, 1540-42, 1551



### 9.1533.08 *Pedestal Bracket*

**DESCRIPTION** Pedestal swivel bracket to suit most work lamps.



### 9.1531.08 *Pipe Socket Base*

**DESCRIPTION** Ultra beam pipe socket base. The pipe socket mounting system allows these work lamps to be mounted on vehicles and removed again quickly. Suitable for applications where there is only a brief need for a work light.

**FEATURES** Integrated power feed is via the pipe socket. No separate wiring is necessary for the work lamp. Tightening the wing nut attaches the pipe socket attachment tightly to the base. Suitable for P/N's 8007, 8007FM, 8007RA, and 8008.

**TO SUIT** P/N's 1500, 1530-32, 1533-35, 1540-42, 1551



### 9.1533.05 *Plug and Lead to suit 1533 Work Lamp*

**DESCRIPTION** AMP - 2 pin plug and 150mm cable.

**TO SUIT** P/N 1533 (except 1533-H9)



### 9.1533H9.05 *Plug and Lead to suit H9 Bulb*

**DESCRIPTION** 2 pin plug to fit H9 bulb, with 2m sheathed cable.

**TO SUIT** P/N 1533-H9



### 9.1520.07 *Spiral Cable Complete Plug*

**DESCRIPTION** Plug and 2m extendable sheathed cable.

**TO SUIT** P/N's 1520 - 25.



### 9.1549.05 *Plug and Lead to suit G4 HID Work Lamps*

**DESCRIPTION** 2 pin Deutsch plug and 2.5m sheathed cable.

**TO SUIT** P/N's 1548, 1549 and 1551.



### 9.1534.05 *Connector for G3 HID Power Pack*

**DESCRIPTION** Plug, terminals and seals for generation 3 HID Gas Discharge power packs.

